



© JAMES THOMAS ENGINEERING LTD 1994
 ALL DIMENSIONS IN mm
 UNLESS STATED, DO NOT SCALE. IF IN DOUBT ASK. THIRD ANGLE PROJECTION

CUSTOMER: STANDARD PRODUCT
 DRAWN BY: PJS
 POSITION TOLERANCE: +/- 1.5mm UNLESS STATED
 ANGULAR TOLERANCE: +/- 2.0 DEGREES UNLESS STATED
 SQUARENESS TOLERANCE: +/- 1.0 DEGREES UNLESS STATED
 START DATE: 08/03/94
 SCALE: NTS
 PROJECT: -

PRODUCT: TRUSS / TOWER ACCESSORIES
 DRAWING TITLE: ROLLER BEAM PULLEY WHEEL ASSEMBLY DRAWING

PART No. B4102
 SHEET No. 1 OF 1
 DRAWING No. B4102-S
 DRAWING TYPE 1/2
 ISSUE 3

This drawing/document is COPYRIGHT and the property of JAMES THOMAS ENGINEERING LTD. It must not be copied (in whole or in part), used for manufacture or otherwise disclosed without the written consent of the company. Any copies of this drawing/document made by any method must include a copy of this legend.

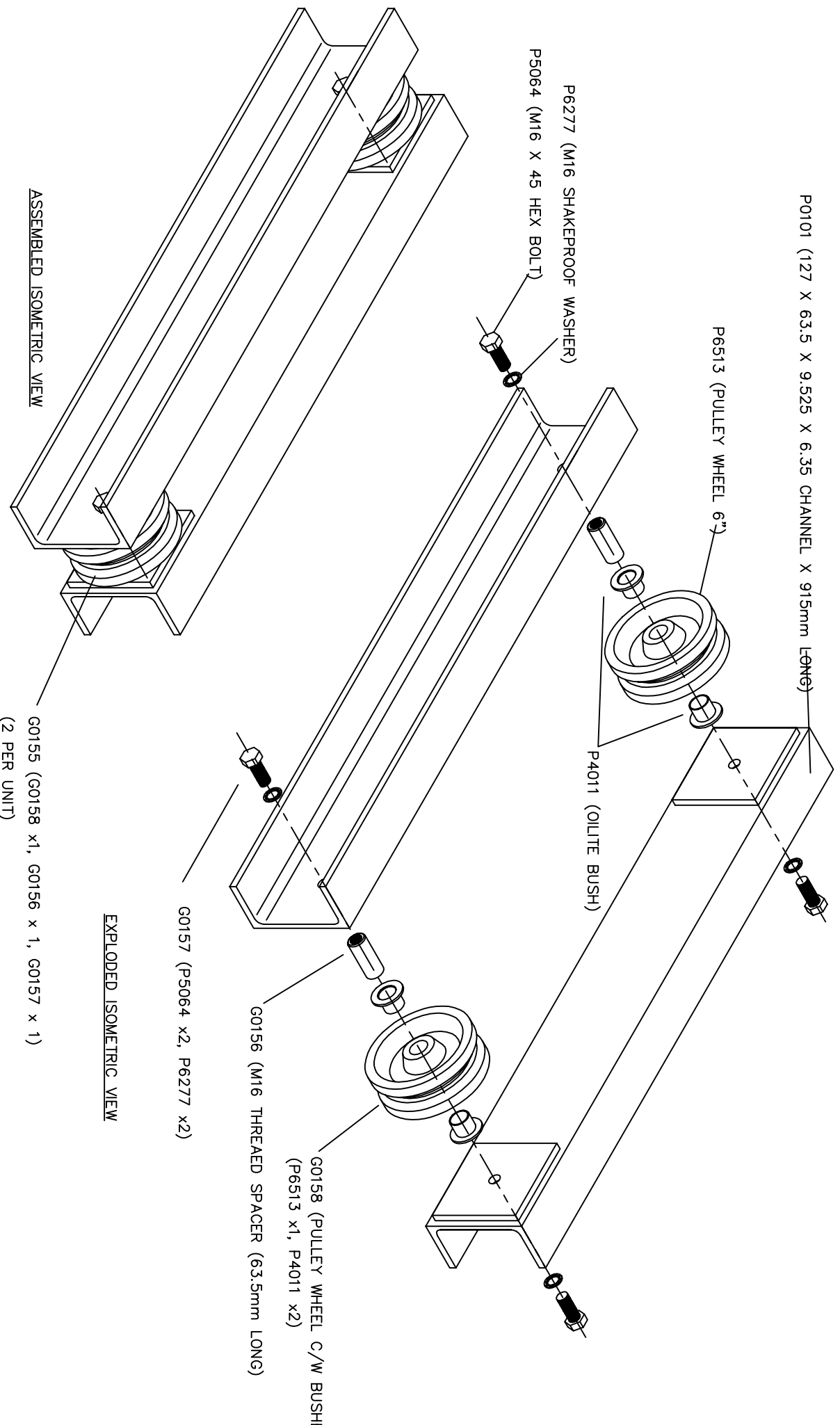

P0101 (127 X 63.5 X 9.525 X 6.35 CHANNEL X 915mm LONG)

P6513 (PULLEY WHEEL 6")

P4011 (OILITE BUSH)

P6277 (M16 SHAKEPROOF WASHER)

P5064 (M16 X 45 HEX BOLT)

G0158 (PULLEY WHEEL C/W BUSH (P6513 X1, P4011 X2))

G0156 (M16 THREADED SPACER (63.5mm LONG))

G0157 (P5064 X2, P6277 X2)

ASSEMBLED ISOMETRIC VIEW

EXPLODED ISOMETRIC VIEW

G0155 (G0158 x1, G0156 x1, G0157 x1) (2 PER UNIT)