

MOVING LIGHT TRUSS

Moving Light truss has been designed around the Pre-rigged truss size. 91" x 30" x 26" in size (other sizes are available). It is manufactured from aluminium tube 6082-T6 with 2" x .125" wall thickness for main tubes and 1" x .125" wall tube for the diagonals. Each truss piece has 8 castor wheels for easy maneuverability and bolts for the connection of truss pieces.

Each 91" truss is designed to carry 3 moving light fixtures. The moving lights are stored internally in the truss and can be lowered to the working position when in use. This design reduces the amount of space required for lighting and rigging in the truck. .

Two handles allow the lowering of each moving light. The following units have been tried in our moving light trusses. Highend Studio Color and Studio Spot.

Coemar CF7 wash fixture

Martins line of Mac fixtures; 250, 300, 500, 600, and 2000

Other fixtures may fit within the design of this truss by using a custom fitted plate.

The whole system can be used with our Ground Support System by using suitable sleeve blocks and towers.

Please note no fixtures are included with truss.

PRODUCT CODE	DESCRIPTION	WT lbs
MLT-120-R3	10' section (empty)	193**
MLT-91-R3	7' 7" section (empty)	145**
MLT-42-R3	42" section (empty)	97**
B4300	2 way corner block	52.9
B4301	4 way corner block	61.75
B4302	Universal pivot section 0-270 degree	59.5
B4303	Universal pivot section 0-90 degree	59.5
B4304	Horizontal load-bearing pivot section	123.5
B4305	Vertical load-bearing pivot section	123.5
B4306	P.R.T. to G.P. Adapter	28.65
**all weights subject to correction		

Allowable Load Data empty MLT	Maximum Allowable Uniform Loads		Maximum Allowable Center Point Loads	
	Span 7'-7" sections feet (meters)	Loads pounds (kgs)	Maximum deflection inches (mm)	Loads pounds (kgs)
2) 15.17 (4.62)	6926 (3141)*	0.63 (16)	3463 (1570)	0.945 (24)
3) 22.75 (6.93)	6084 (2759)	1.26 (32)	3042 (1379)	1.26 (32)
4) 30.33 (9.25)	4404 (1997)	1.69 (43)	2202 (998)	1.69 (43)
5) 37.92 (11.56)	3341 (1515)	2.09 (53)	1670 (757)	2.09 (53)
6) 45.5 (13.87)	2622 (1189)	2.72 (69)	1311 (594)	2.72 (69)
7) 53.08 (16.18)	2080 (943)	3.66 (93)	1040 (471)	3.66 (93)
8) 60.67 (18.5)	1617 (733)	4.72 (120)	808 (366)	4.72 (120)

LOADING FIGURES show maximum loads between supports in addition to self weight of truss. Information extracted from structural report by The Broadhurst Partnership. * Denotes load limited to suit maximum shear capacity. All loads include a 20% overload factor for dynamic effects.

MOVING LIGHT TRUSS

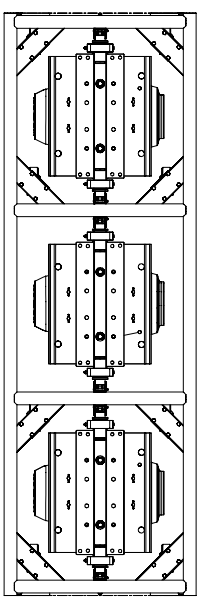
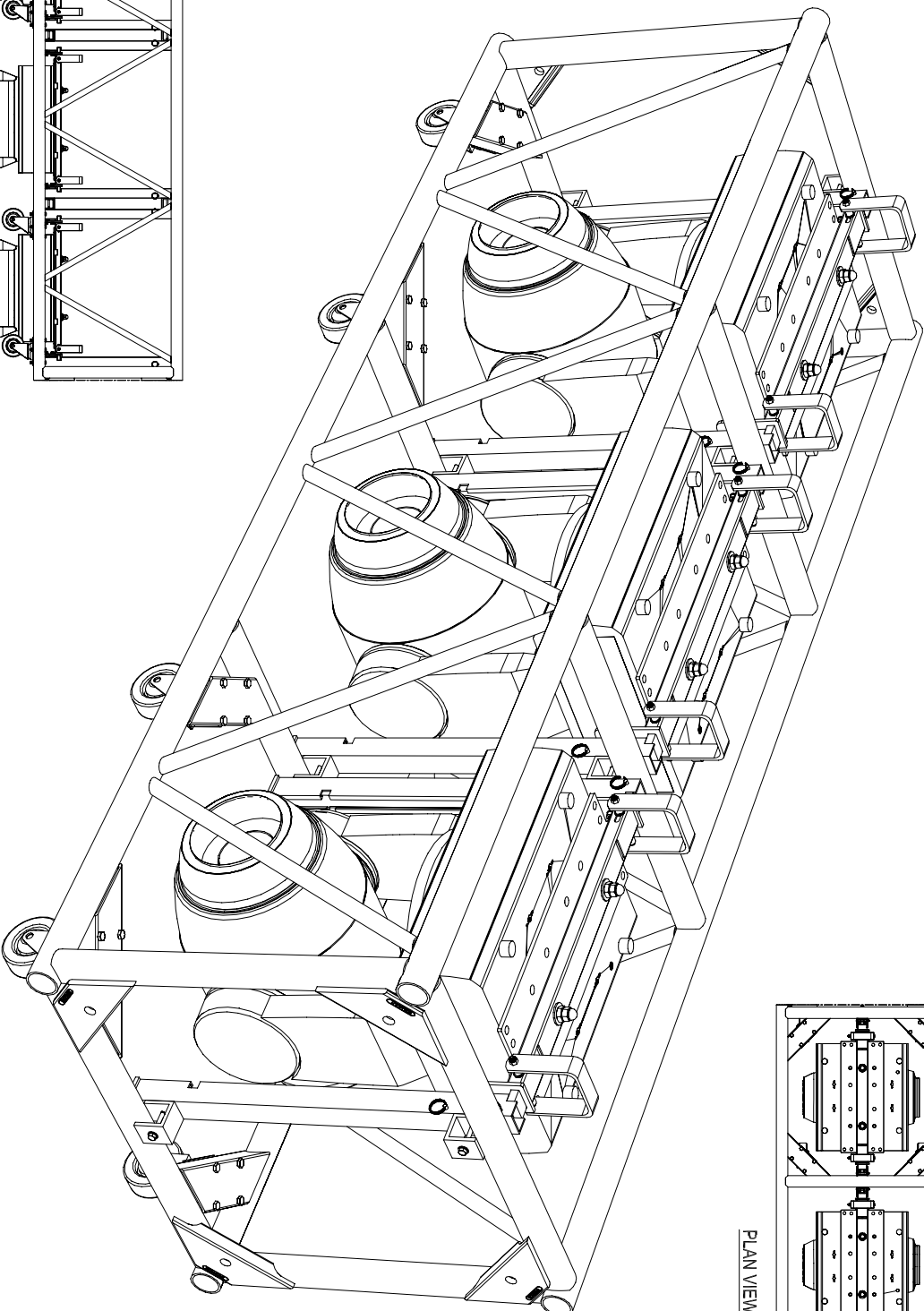

PLAN VIEW

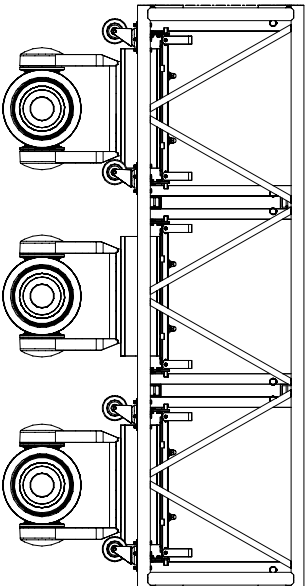

FRONT VIEW with LIGHTS IN LOWERED POSITION

MOVING LIGHT TRUSS
30" WIDE X 26" TALL

ACCOMMODATES WIDE VARIETY OF MOVING LIGHTS
*SIZE SHOWN IS 91"