

# Squarelite truss

This light weight truss is ideal for Exhibition, Conference and Small venue work. Using the Supertruss design principles has enabled the manufacture of a competitively strong but lightweight truss with all the innovative space and time saving characteristics first demonstrated in Supertruss. Squarelite is available as a 12" or 15.75" square truss manufactured from 6061T6 or 6082T6 alloy aluminum tube with 1.96"x 0.078 wall main tubes, 0.75"x 0.078" wall diagonals on all faces and featuring double ended connecting forks for ease of assembly and added strength. All trusses are supplied with pin & "R" clips or bolt sets as necessary.

Squarelite truss Type	12 inch Squarelite		15.75 inch Squarelite	
	Code	Lb	Code	Lb
12 foot Section	B3960	41.8	B3460	52.7
10 foot Section	B3961	34.87	B3461	43.9
8 foot Section	B3962	27.9	B3462	35
6 foot Section	B3963	20.92	B3463	26.3
5 foot Section	B3964	17.44	B3464	22
2.5 foot Section	B3965	8.7	B3465	11
3 metre Section	B3930	32.4	B4330	39
1 metre Section	B3910	14.8	B4310	17.2
2 way / 90° gate	B3902	13.2	B3499	15.4
3 way / 120° gate	B3903	10.1	B3498	11.7
Square support plate per pair	B3908	6.9	B3408	12.7
Base Plate Vertical Connecting Spigots	B3901	6.4	B3497	9.5
Horizontal to Vertical Connecting Spigot	B1606	1	B1606	1
Vertical Connecting Spigot	B1608	0.8	B1608	0.77
Baby Tower Sleeve Plates per pair	B3909	11.7	B3496	16

12" Squarelite truss

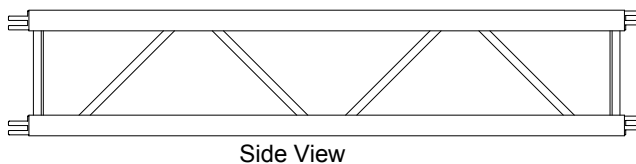
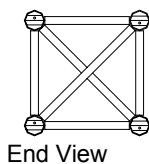
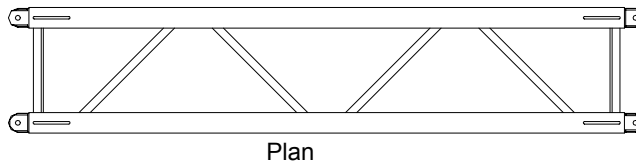

15.75" Squarelite truss

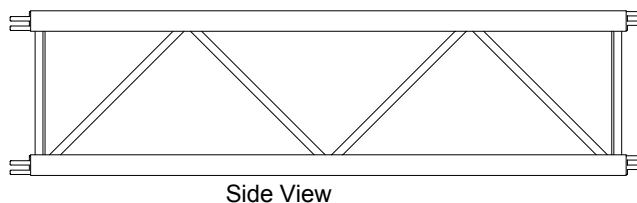
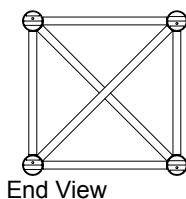
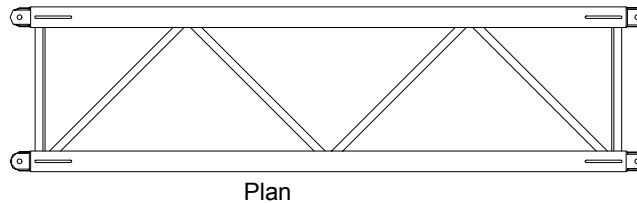

# Squarelite truss

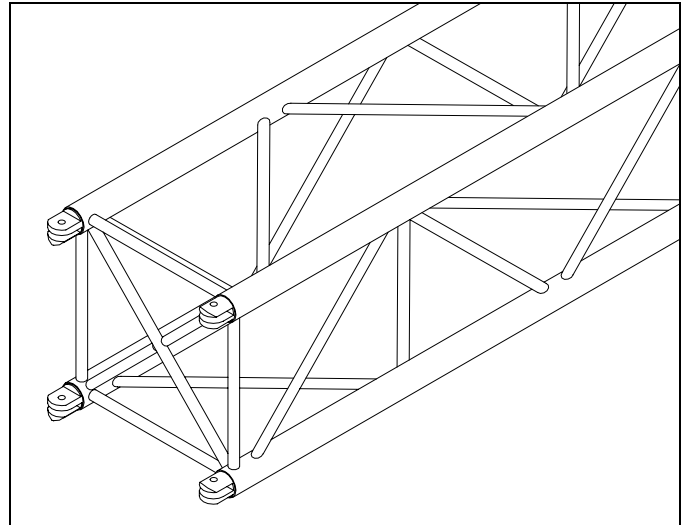

LOADING FIGURES show maximum loads between supports in addition to self weight of truss. Information extracted from structural report by The Broadhurst Partnership for truss manufactured after June 1994.

Span feet (meters)	Maximum Allowable Uniform Loads		Maximum Allowable Center Point Loads	
	Loads pounds (kgs)	Maximum deflection inches (mm)	Loads pounds (kgs)	Maximum deflection inches (mm)
10 (3.048)	2354 (1068)	0.28 (7)	1177 (534)	0.28 (7)
20 (6.096)	2332 (1058)	0.96 (23)	1166 (529)	0.96 (23)
30 (9.144)	1296 (588)	2.5 (63)	648 (294)	2.5 (63)
40 (12.192)	842 (382)	3.0 (76)	421 (191)	3.0 (76)

LOADING FIGURES show maximum loads between supports in addition to self weight of truss. Information extracted from structural report by The Broadhurst Partnership. \* Denotes load limited to suit maximum shear capacity. All loads include a 20% overload factor for dynamic effects.

Span feet (meters)	Maximum Allowable Uniform Loads		Maximum Allowable Center Point Loads	
	Loads pounds (kgs)	Maximum deflection inches (mm)	Loads pounds (kgs)	Maximum deflection inches (mm)
10 (3.048)	2348 (1065)	0.16 (4)	1175 (533)	0.16 (4)
20 (6.096)	2324 (1054)	0.47 (12)	1161 (527)	0.47 (12)
30 (9.144)	2273 (1031)	2.13 (54)	1137 (516)	2.13 (54)
40 (12.192)	1759 (798)	2.95 (75)	879 (399)	2.95 (75)
50 (15.24)	873 (396)	3.94 (100)	436 (198)	3.94 (100)
60 (18.29)	632 (283)	4.45 (113)	313 (142)	4.45 (113)

LOADING FIGURES show maximum loads between supports in addition to self weight of truss. Information extracted from structural report by The Broadhurst Partnership. \* Denotes load limited to suit maximum shear capacity. All loads include a 20% overload factor for dynamic effects.

# Squarelite truss

## 2 Way Connection

The 2 way joint is simply made by connecting the inside truss spigots and inserting a 2 way gate to join the outer truss tubes together. All joints are pinned using 12mm Pins and "R" clips.

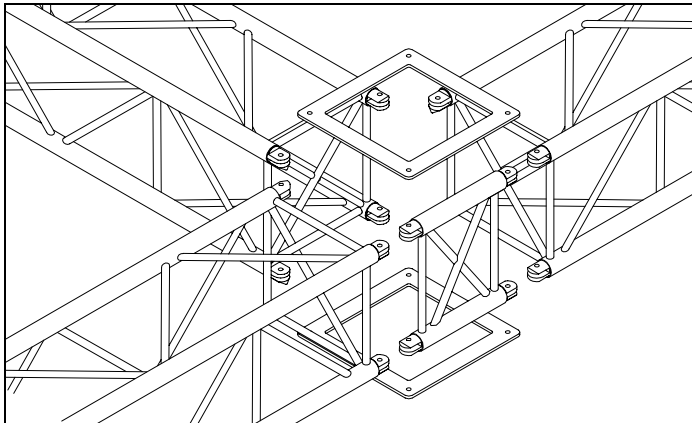
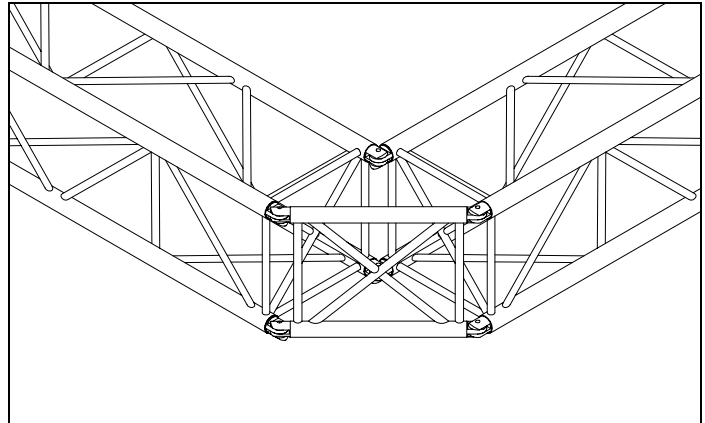

## 3 Way Connection

The 3 way joint is made by joining the 3 trusses together fitting a square support plate above and below the tubes of the truss locating through the spigot holes. Add the 3 way gate to the open face and join together with M12 bolt sets.

## 4 Way Connection

The 4 way joint is made by joining the 4 trusses together fitting a square support plate above and below the tubes of the truss locating through the spigot holes and joining together with M12 bolt sets.

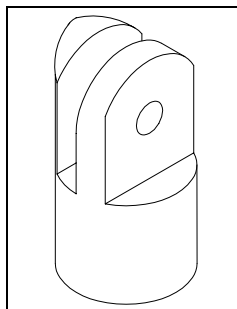
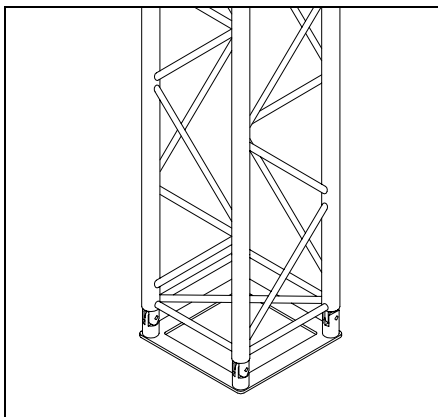
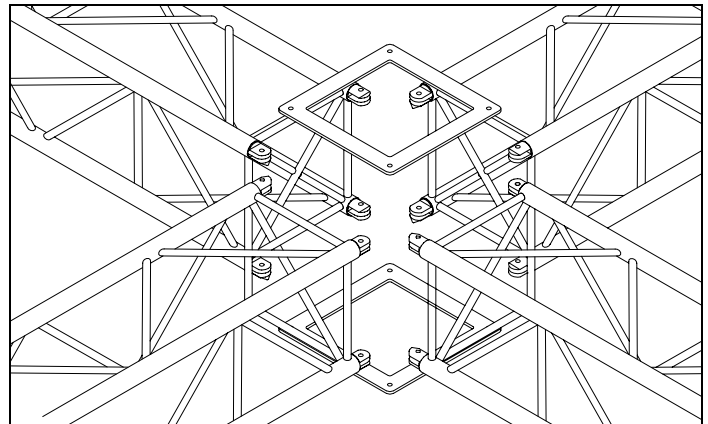

B1608 - Vertical connecting spigot

## Base Plate

The base plate is supplied with 4 vertical connecting spigots. This plate can also be used on 3 and 4 way joints as a support and vertical truss plate.